

TAILWHEELS

ALASKAN BUSHWHEEL INC. 3200 TAILWHEEL ASSEMBLY

The Alaskan Bushwheel Tailwheel Assembly is an FAA-PMA (PMA # PQ1557NM, Supplement 9) replacement part for the Scott 3200 assembly and parts contained therein, includes Heavy Duty Steering Arm. One Year Warranty.

ABI-3200 Standard Tailwheel Assembly(3214 Standard Arm)	P/N 06-00836
ABI-3224A Standard Tailwheel Assembly(3214T Heavy Duty Arm)	P/N 06-00722
ABI-3200B Tailwheel Tundra Assembly.....	P/N 06-00723
ABI-800613-00 Pawnee 2-bolt Tailwheel Head	P/N 06-00820
ABI-2600A 4" wheel halves with 2.80x2:50x4 tire & tube mounted and ready to go.....	P/N 06-01190

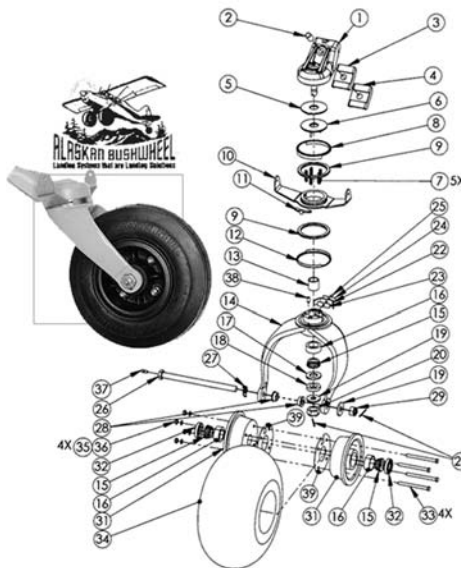

#	Part No.	Description	Part No.	Price	#	Part No.	Description	Part No.	Price
1	ABI-3216-00	Bracket Assy.	06-00724	.	17	ABI-1863	Grease Retainer	06-00746	.
2	ABI-3241-3S****	Spacer	06-00725	.	18	ABI-2504-1	Spacer	06-00752	.
3	ABI-3243-02****	Leaf Spring Adapter 1-3/4" to 1-1/4"	06-00810	.	19	AN960-816	Washer	AN960-816	.
4	ABI-3243-01****	Leaf Spring Adapter 1-3/4" to 1-1/2"	06-00811	.	20	AN320-8	Shear Nut	AN320-8	.
5	ABI-3207-00	Fiber Thrust Washer	06-00726	.	21	MS24665-283	Cotter Pin	MS24665-283	.
6	ABI-3235-00	Thrust Plate Assy.	06-00727	.	22	ABI-3222-00	Compression Spring	06-00737	.
7	ABI-3233-00	Compression Spring	06-00728	.	23	ABI-3258-00	Spacer	06-00738	.
8	ABI-3256-02	Hvy-Dty Dust Cap, Upper	06-00729	.	24	ABI-3258-01	Spacer	06-00739	.
	ABI-3255-02	Std. Dust Cap, Upper	06-00814	.	25	ABI-3257-00	Pin	06-00740	.
9	ABI-3206-00	Thrust Washer	06-00730	.	26	ABI-872*	Axle	06-00741	.
10	ABI-3214T	Hvy-Dty Standard steering arm assy.	06-00731	.	26A	ABI-3236**	Axle	---	---
10A	ABI-3214-00	Standard Standard steering arm assy.	06-00812	.	27	ABI-3225-00	Tab Lock Washer	06-00742	.
11	ABI-3219-00	PAWL	06-00732	.	28	ABI-3227-00	Spacer	06-00743	.
12	ABI-3256-1	Hevt-Duty Dust Cap, Lower	06-01264	.	29	33475-008	Castle Nut	AN310-8	.
	ABI-3256-1	Std. Duty Dust Cap, Lower	06-00733	.	30	ABI-S2*	Rim Spacer	06-00744	.
	ABI-3235-01	Std. Duty Dust Cap, upper	06-00813	.	31	ABI-3244-00	Wheel Half	06-00745	.
13	ABI-3205-00	Bushing	06-00734	.	32	ABI-7024	Bearing Race Seal	06-00746	.
14	ABI-F1*	Tailwheel Fork	06-00735	CALL	33	AN4-34A*	Wheel Bolt	AN4-34A	.
14A	ABI-3224**	Tailwheel fork Std.	06-00736	.	33A	AN4-7A**	Wheel Bolt	AN4-7A	.
15	A4050	Cone Bearing	13286	.	34	1154R*	Tire	---	---
16	A4138	Bearing Race	13287	.	34A	280 x 2.50 x 4**	Tire	06-00748	.
					35	33478-202	Self Locking Nut	33478-202	.
					36	1/4" Washer	Flat Washer	AN960-416	.
					37	T7201	Zerk Fitting	06-00753	.
					38	ABI-232-046	Dowel Pin	06-00749	.
					39	ABI-2602**	Gasket	06-00750	.

* Parts not included in ABI-3200/ABI-3224A Assembly

** Parts not included in ABI-3200B Assembly
Parts in red are not sold individually.

*** Parts not included in assemblies.



REPLACEMENT PARTS FOR SCOTT 3200 TAILWHEEL

The Scott Model 3200 tailwheel, with 8" pneumatic tire, is designed to give years of trouble-free service. The swivel mechanism is designed to keep out water, sand and mud. Grease fittings are provided for lubrication. Bracket fits 1-3/4" wide tailwheel leaf spring. Wt. 7-1/2 lbs. Attaching hardware not furnished.

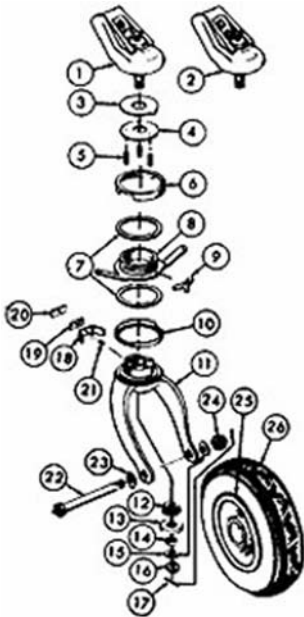

Item No.	Part No.	Description	No. Req'd	Price Ea.
1	3216	Bracket Ass'y	1	.
2	800613	Bracket Ass'y*	1	.
3	3207	Washer, Thrust	1	.
4	3234	Thrust Plate Ass'y	1	.
5	3233	Spring, Compression	5	.
6	3235-2	Dust Cap	1	.
7	3206	Washer, Thrust	2	.
8	3214	Arm Assembly	1	.
9	3219	Pawl	1	.
10	3235-1	Dust Cap	1	.
11	3224	Fork Ass'y	1	.
12	13286	Cone Bearing	1	.
13	1863	Retainer, Grease	1	.
14	2504-1	Spacer	1	.
15	18107	Washer, AN960-816	2	.
16	18450	Nut, Shear AN320-8	1	.
17	18482	Pin, Cotter	2	.
18	3222	Spring	1	.
19	3258	Spacer	1	.
20	3258-1	Spacer	1	.
21	3257	Pin	1	.
22	3236	Axle Ass'y	1	.
23	3225	Washer, Lock	1	.
24	18443	Nut, Castle, AN310-8	1	.
25	3244	Wheel Ass'y	1	----
26	2600	Tire & Wheel Ass'y	1	----

SCOTT MODEL 2600 8-INCH PNEUMATIC TIRE

The Model 2600 8" pneumatic tire and wheel assembly is used on the 3200, 3250, 3400 and 3425 Series tailwheel assemblies. The Model 3245-1 10" pneumatic tire and wheel assembly is used on the 3425 & 3450 Series tailwheel assemblies. Total Wt. 3 lbs. 13 oz.

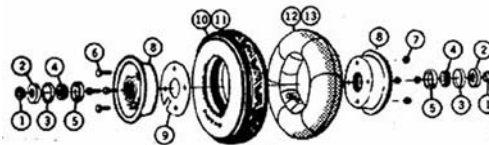

Item No.	Part No.	Description	8" Assy P/N 2600	10" Assy P/N 3245-1	Price Each
1	3227	Spacer	2	2	.
2	1863	Retainer, Grease	2	2	.
3	1862	Spacer	2	2	.
4	13286	Bearing Cone (A-4050)	2	2	.
5	13287	Bearing Cup (A-4138)	2	2	.
6	18438	Bolt	4	4	.
7	33478-202	Nut, Self Locking	4	4	.
8	2598	Hub	2	2	---
9	2602	Gasket	1	1	.
10	3228	8" Tire	1		.
11	06-08100	10" Tire		1	.
12	3223	8" Tube	1		.
13	3247	10" Tube		1	.

SCOTT LEAF SPRING SPACERS AND SPRING KITS

3241-3S - Spacer Only.....	P/N 06-00406
3243-2 - Spacer Only	P/N 06-00407
3241-1S - Adapter Kit - Converts 1-3/4" 3216 (1 3/4") bracket to 1-1/2" width.	P/N 06-00408
3239 - Heavy Duty Tension Spring Kit.....	P/N 06-00008
3243-01 - Converts 1-3/4" Bracket to 1-1/4" Bracket. Used on 3200 Tailwheel.....	P/N 06-00421