

TAILWHEELS

MAULE MODEL SFSA SOLID TAILWHEELS

The SFSA tailwheel assembly is of the same type construction as the SFS-P8A unit except for the tire, which is a 6.50 x 2.50 soft rubber solid tire. Spring connector kit not furnished with this model. FAA-approved. Wt. 6 lbs.

- SFSA-1-4, for 1-1/4" Spring P/N 06-16710.....
 SFSA-1-2, for 1-1/2" Spring P/N 06-16720.....
 Replacement Tire & Bearings P/N TW-23A.....

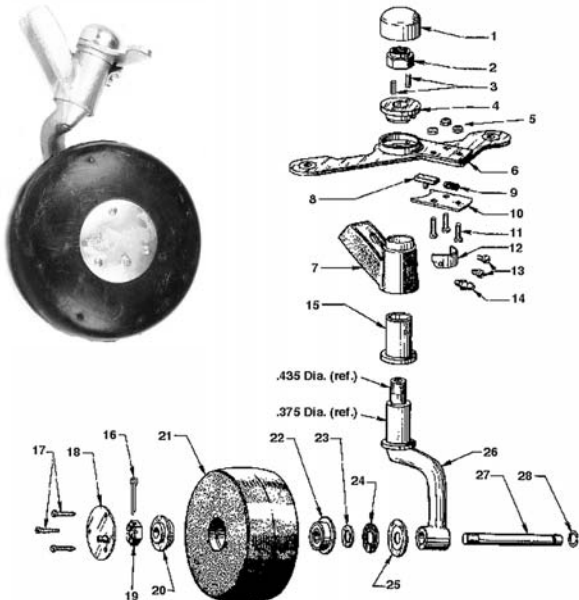

MAULE MODEL SFS-P8A PNEUMATIC TAILWHEELS

An inexpensive 8" pneumatic tailwheel assembly which is steerable and full swiveling, with new improved single arm shimmy-free fork. All working parts heat treated. FAA approved. Wt. 7 lbs.

- Maule Tailwheel #SFS-P8A-1-4* P/N 06-16760.....
 Maule Tailwheel #SFS-P8A-1-2** P/N 06-16740.....
 McCreary Tire 2.80/2.50-4 4 Ply P/N 06-08000.....
 McCreary Tube 280 X 250 X 4 P/N 06-08101.....
 * - For 1-3/4" Leafspring ** - For 1-1/2" Leafspring

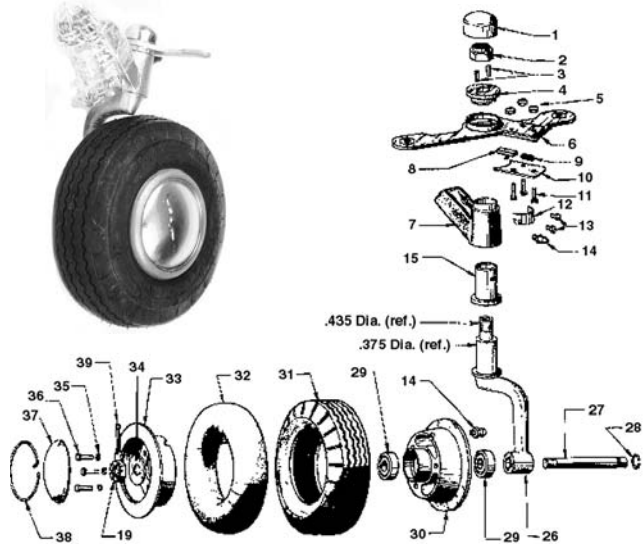

LG

MAULE P8B TUNDRA TAILWHEEL

A new tailwheel with 8" pneumatic tire designed and engineered to meet the toughest conditions on all types of airports and landing fields.

- SFS-P8B-1-4 For 1-1/4" Leaf Spring Width P/N 06-16750.....
 SFS-P8B-1-2 For 1-1/2" Leaf Spring Width P/N 06-16760.....
 SFS-P8B-3-4 For 1-3/4" Leaf Spring Width P/N 06-16770.....

MAULE TAILWHEEL PARTS LIST

#	Description	Old Style (Pre 1976) has 3/4" Fork Shaft & New Style (Post 1976) has 7/8" Fork Shaft	Old Style SFS-P8 Pneumatic or SFS Solid Rubber	New Style SFS-P8A Pneumatic and SFSA Solid Rubber	Qty. Req.	Price Each
		Part Number	Part Number	Part Number		
1	Cover Cap	TW-18 (1-1/4")	TW-63A (1-3/8")		1	.
2	Nut	AN364-720A or AN365-720	AN364-720A or AN365-720		1	.
3	Lock Ring Pin	TW-17	TW-60AB		1/2	.
4	Lock Ring	TW-16	TW-57		1	.
5	Nut	AN364-440A	AN364-440A		3	.
6	Steering Arm Assembly*	TW-15 (TW-13 & TW-16 are included in this Assembly)	TW-15A		1	.
7	Bracket Assy., 1-1/4 In	06-16101	06-16201		1	.
	Bracket Assy., 1-1/2 In	06-16102	06-16202		1	.
8	Lock Pin	TW-13	TW-13		1	.
9	Steering Arm Spring	TW-14	TW-14		1	.
10	Lock Cover Plate	TW-12	TW-12		1	.
11	Screw	MS35206-217	MS35206-217		3	.
12	Cam	TW-10	TW-10		1	.
13	Screw	AN501-A10-4	AN501-A10-4		2	.
	AN520-10-4	AN520-10-4				
14	Zerk Fitting	TW-7-A14	TW-7-A14		1	.
15	Oilite Bearing	TW-7 (3/4" I.D.)	TW-59A (7/8" I.D.)		1	.
Items 16 through 25 are for the solid rubber tire assembly only.						
16	Cotter Pin	AN380-3-3	AN380-3-3		1	.
17	Screw	TW-A18	TW-A18		3	.
18	Hub Cap	TW-27	TW-27		1	.
19	Axle Nut	AN320-8	AN320-8		1	.
20	Bearing	TW-3	TW-3/A15		1	.
21	Tire—solid, no bearings	TW-23	TW-23		1	.
	Tire—solid, with bearings	TW-23A	TW-23A		1	.
22	Bearing (with washer)	TW-A15	TW-A15		1	.
23	Washer	TW-28	TW-28		1	.
24	Felt Seal	TW-26	TW-26		1	.

#	Description	Old Style (Pre 1976) has 3/4" Fork Shaft & New Style (Post 1976) has 7/8" Fork Shaft	Old Style SFS-P8 Pneumatic or SFS Solid Rubber	New Style SFS-P8A Pneumatic and SFSA Solid Rubber	Qty. Req.	Price Each
		Part Number	Part Number	Part Number		
25	Retainer Washer Fork (with axle)	TW-64	TW-64		1	.
	Pneumatic	06-00092	TW-58A		1	.
	Solid Rubber	06-00093	TW-61A-1		1	.
27	Axle	TW-5	TW-5		1	.
28	Axle Sircclip Ring	TW-6	TW-6		1	.
29	Bearing	TW-A7	TW-A7		2	.
30	Inboard Wheelhalf, with bearings	TW-30	TW-30		1	.
31	Tire, 8-inch				1	-----
32	Tube				1	-----
33	Outboard Wheelhalf	TW-31	TW-31		1	.
34	Washer	TW-A6	TW-A6		1	.
35	Lock Washer	AN935-516	AN935-516		3	.
36	Bolt	TW-A12	TW-A12		3	.
37	Hub Cap	TW-32	TW-32		1	.
38	Hub Cap Sircclip Ring	TW-33	TW-33		1	.
39	Cotter Pin	AN380-3-3	AN380-3-3		1	.
Items 40 through 44 are used on the "Old" style & Pneumatic tailwheel that have a shimmy dampener.						
40	Adjusting Screw	TW-40			1	.
41	Dampener Spring	TW-41			1	.
42	Friction Block	TW-42			1	.
43	Hex Housing	TW-43			1	.
44	Bracket Assembly, 1-1/4 inch drilled	TW-44-1-4			1	-----
	Bracket Assembly, 1-1/2 inch drilled	TW-44-1-21				-----