

BEARINGS – UNIVERSAL JOINTS

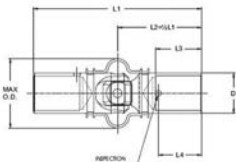

MS20271 UNIVERSAL JOINTS

Built to conform with and exceed all requirements stipulated in Spec. MIL-J-6193A. High axial and torsional strengths, high strength-weight ratio, no replacement during anticipated service life of aircraft on most installations, permanent lubrication.

Part No.	Nominal Size (In.)	Price Ea
MS20271-B6	3/8	.
MS20271-B8	1/2	.
MS20271-B10	5/8	.
MS20271-B12	3/4	.
MS20271-B14	7/8	.



Dash #	+.000, -.002 (+.000, -.051) Outside Dia.		+/- .015 (+/- .381) Overall Length		+.031, -.000 (-.787, -.000) Bore Depth		+.004, -.025 (+.102, -.025) Bore Dia.		+/- .015 (+/- .381) Insp. Hole Loc.		Max Dia. (+.102, -.025) Cover Dia.		Weight Max		Price
	in	mm	in	mm	in	mm	in	mm	in	mm	in	mm	lbs.	kg.	
B6	.372	9.45	2.0	50.80	.500	12.70	.250	6.35	.437	11.10	.781	19.84	.07	.032	.
B8	.495	12.57	2.625	66.67	.625	15.88	.375	9.52	.562	14.27	1.031	26.19	.09	.041	.
B10	.620	15.75	2.750	69.85	.750	19.05	.500	12.70	.687	17.45	1.156	29.36	.18	.082	.
B12	.745	18.92	3.187	80.95	.875	22.22	.625	15.88	.812	20.62	1.437	36.50	.24	.109	.
B14	.870	22.10	3.625	92.07	1.00	25.40	.750	19.05	.937	23.80	1.562	39.67	.35	.159	.

*Five hour test at 15° angle.

TORSIONAL OVERLOADS

AXIAL OVERLOADS



Temporary torsional overloads as great as 80% of rated ultimate have been handled by these universal joints without harmful binding.

Temporary axial overloads ranging up to 150% in excess of rated ultimate have been imposed without binding. These characteristics insure high safety factors under the most difficult operating conditions.



H-9426 BALL JOINT

* Hex: 1/2 Inch * Thread: 5/16-18 * Ball: 10 mm
P/N 06-00675.....

BALL JOINT ASSEMBLIES

COMMERCIAL

Ball Joint Style	Female End	Male End	Part No.	Price
Is similar to AN276-6 but no longer tapered	1/4-28	1/4-28	05-07300	.
Commercial	10-32	1/4-28	05-07400	.
Commercial	10-32	10-32	05-07500	.
Commercial	1/4-28	1/4-28	05-07600	.

GEARS, CHAINS, SPROCKETS AND BEARINGS



BOSTON GEAR PRODUCTS

STEEL SPROCKETS - These sprockets have many applications in a control system. Hub type.

Part No.	Chain No.	Size	Teeth	Price
05-03441	1/4"	12		
25B15	1/4"	15		
05-03442	1/4"	20		
35B14	3/8"	14		

BUSHINGS - As used on the Solitaire Sailplane.

Bushing Part No.	Price
FF520-10	.
FF620	.

ROLLER CHAIN - These chains fit above sprockets.

1/4" Chain - 10 Ft.	P/N 05-29325	.
3/8" Chain - 10 Ft.	P/N 05-29335	.
Extra Links - S25	P/N 05-29300	.
Extra Links - S35	P/N 05-29350	.
FB-35-1.....Flange Bearing	G-481-G Gear	.
FB-35-2.....Flange Bearing	G-481Y-P Pinion	.
FB-1012-4.....Flange Bearing	NF-14-6-8 Bearing	.
FB-1013-8.....Flange Bearing	NF-16-8-9 Bearing	.
FB-1620-10.....Flange Bearing		.
FB-46-2.....Flange Bearing		.

COMPLETE LINE OF BOSTON GEAR PRODUCTS AVAILABLE

BRONZE BUSHINGS SS-610-8

Cast Bronze bearings fit a wide range of applications.

Key Benefits:

High Strength, Excellent Machinability

P/N 04-01937.....



ASSORTED SPRINGS

Spring	Part No.	Application	Spring Type	Length	Price Each
Century Spring #186-C	01-27200	VariEze	Tension	2"	.
Rudder Return Spring	01-27300	"	Tension	4 1/2"	.
Landing Brake	01-27600	VE/Long-EZ	Tension	10"	.
Tension Spring*	01-37500	"	Tension	30"	.
Landing Brake	01-27900	Cozy	Tension	12 1/2"	.

SINTERED BRONZE OIL IMPREGNATED BEARINGS

PLAIN BEARINGS

Part Number	Hole ID	Hole OD	Length	Price
05-01977	3/16	5/16	3/4"	.
05-01976	1/4	3/8	1"	.
05-01974	1/2	3/4	3/4"	.
05-01975	1/2	3/4	3/4"	.
05-01979	9/16	3/4	1"	.
05-01978	5/8	3/4	1"	.
05-01891	3/4	7/8	1"	.

FLANGE BEARINGS

Part Number	Hole ID	Hole OD	Length	Flange OD	Flange Thickness	Price
05-01949	1/4	3/8	1/4"	15/32	1/16	.
05-01947	1/2	5/8	1/2"	7/8	1/16	.
05-01946	1/2	5/8	1"	7/8	1/16	.
05-01948	1/2	3/4	1"	15/16	1/8	.
05-01951	5/8	3/4	1/2"	1	3/32	.
04-01638	5/8	3/4	1"	1	3/32	.
05-01950	3/4	7/8	3/4	1-1/8	1/8	.
05-01945	1	1-1/4	3/4	1-5/8	1/8	.



SINGLE-ROW TAPERED ROLLER BEARINGS

The most basic and widely used tapered bearing, the single-row type consists of the cone assembly and the cup. It is usually fitted as one of an opposing pair. During equipment assembly, single-row bearings can be set to the required clearance (endplay) or preload condition to optimize performance. Single-row tapered roller bearings have positive roller alignment that ensures true rolling motion and generates a "seating force" that pushes the roller against the cone large rib. This seating force prevents the rollers from skewing off apex, thereby keeping them positively aligned and located against the cone large rib.
P/N 05-29749.....

BELLCRANK BEARINGS



Part No.	Bore	Flange Dia.	Race Width	Price Each
BC4W10* (AN218-4)	1/4"	1-5/8"	5/8"	.
BC5W11	5/16"	1-11/16"	5/8"	.

*Military P/N AN218P4 / MS20218-1

All bearings inspected per MIL-I45208A. 100% traceable. Currently installed on new and rebuilt certified aircraft. Prepacked with lubricant conforming to MIL-G-23827

AP